

## Folder 1

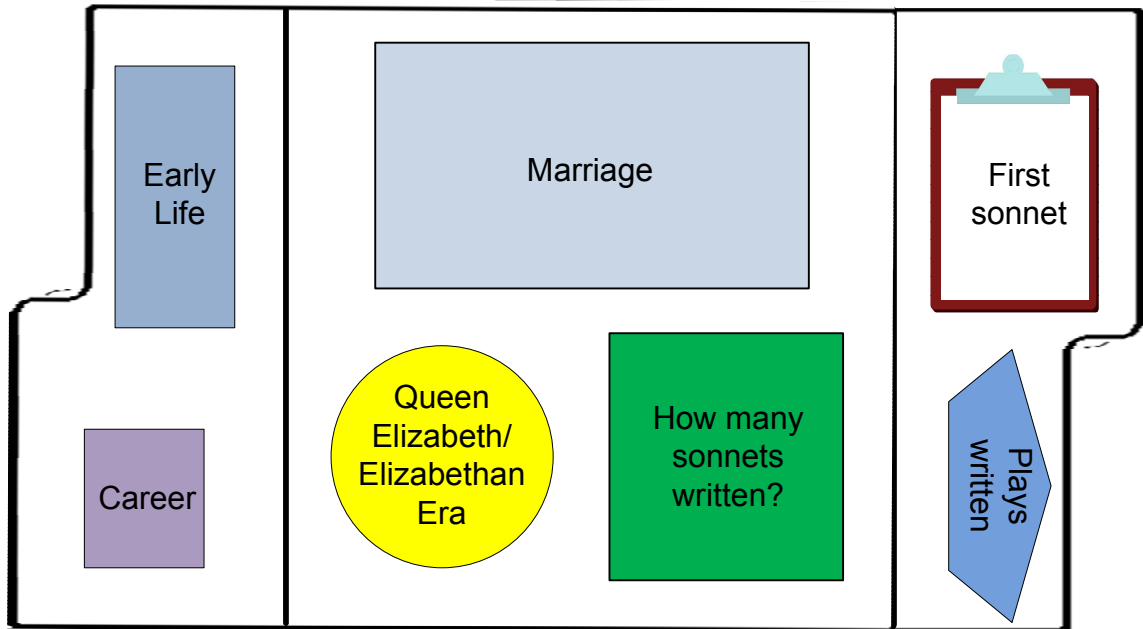

## Folder 2

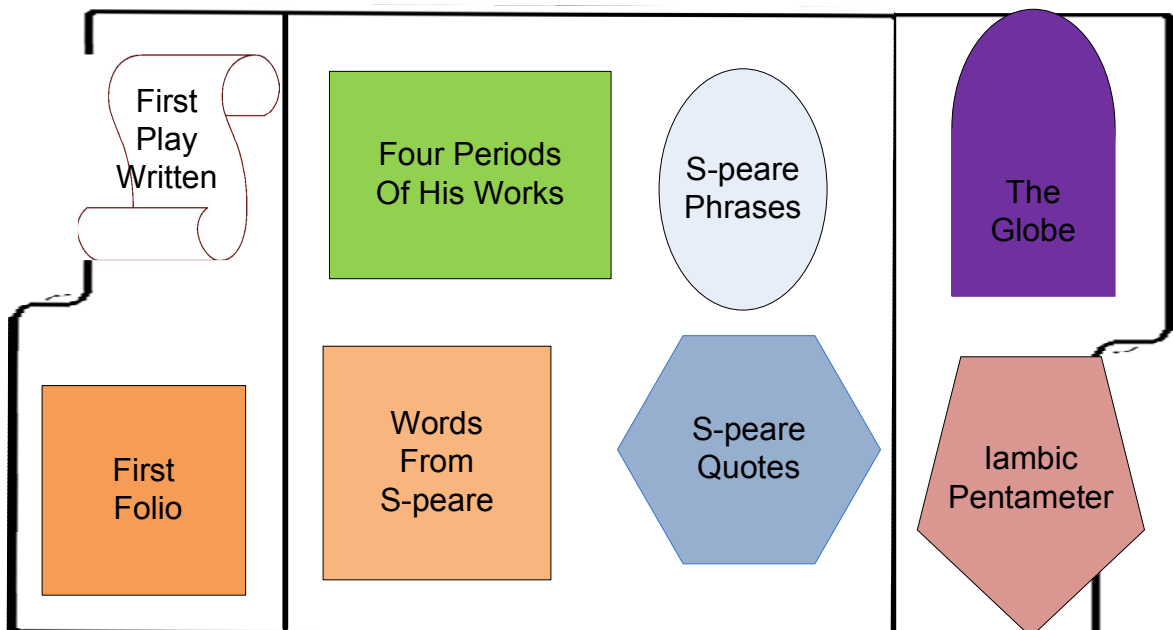



## Table of Contents

Timeline of Shakespeare's Life

The Early Life of Shakespeare

His Career

Shakespeare Marries Anne Hathaway

Queen Elizabeth/The Elizabethan Age

The Writings of Shakespeare

The Works of Shakespeare

The Words of Shakespeare

Famous Quotes of Shakespeare

The Globe

Sonnet-Poem

Iambic Pentameter

Shakespeare Comes to America

## His Career

By this time in London, there was an already established community of playwrights. In 1595, Shakespeare was named as one of the senior members of the Lord Chamberlain's Men. This was an acting company that performed before the court during Queen Elizabeth's reign and by 1603 had become one of the two leading companies in London. The company's name was changed to The King's Men after King James took the throne. Shakespeare was named the official playwright of the King of England. This was one of Shakespeare's greatest honors in his early career.

By 1596, Shakespeare was granted a Coat of Arms for his family name. This allowed Shakespeare to call himself a "gentleman." With his new found fortune in 1597, he purchased the second largest house in Stratford which he called New Place. Later, he began buying up land around Stratford. One year later, Shakespeare became a ten percent owner of the new purpose built theatre in London, the famous Globe Theatre. He is often called "The Bard of Avon" or simply "The Bard."

Shakespeare retired in 1611. He returned to Stratford and in 1616 Shakespeare died. In his will, he left his second-best bed to his wife. During this era, that would have been a sign that his marriage may not have been a happy one.



There are only two known portraits of William that still exist today; the widely used engraving of William Shakespeare by Martin Droeshout first published on the title page of the 1623 First Folio and the monument of the great playwright in Stratford's Holy Trinity Church in Stratford.

Folder 1

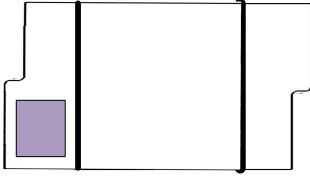

Cut out as one booklet. Fold down flap and then fold over the other. Glue into lapbook. Cut out the labels and glue onto blank sides of booklet. Answer the questions.

What was Lord Chamberlain's Men?

What was The King's Men?

What did Shakespeare do with his money?

When did Shakespeare retire?



Shakespeare's Career



## Folder 2

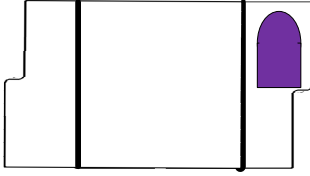

Cut out as one piece. Tri-fold with title page on top. Glue a question square on each section. Glue booklet into lapbook. Answer the questions.

What ultimately happened to the globe?

What was the tiring house?

What was the Pitt used for?

Who built the theater and when?

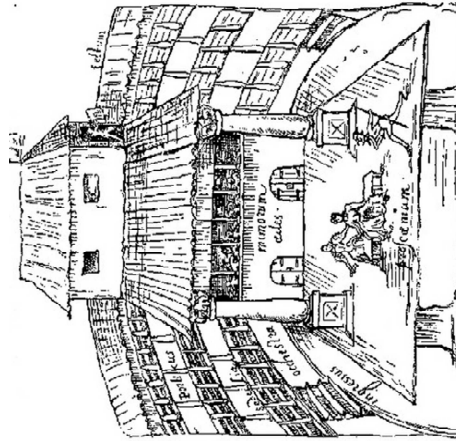

# The Globe