

This guide shows where to place the mini-booklets in each folder.

Folder 1 Weeks 1-7

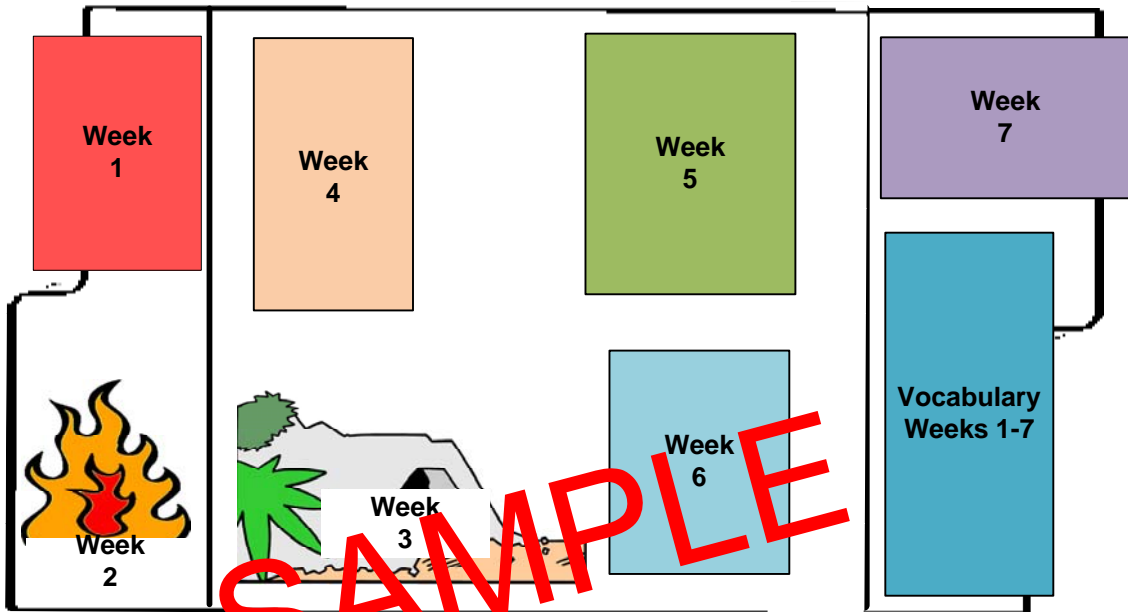

Folder 2 Weeks 8-15

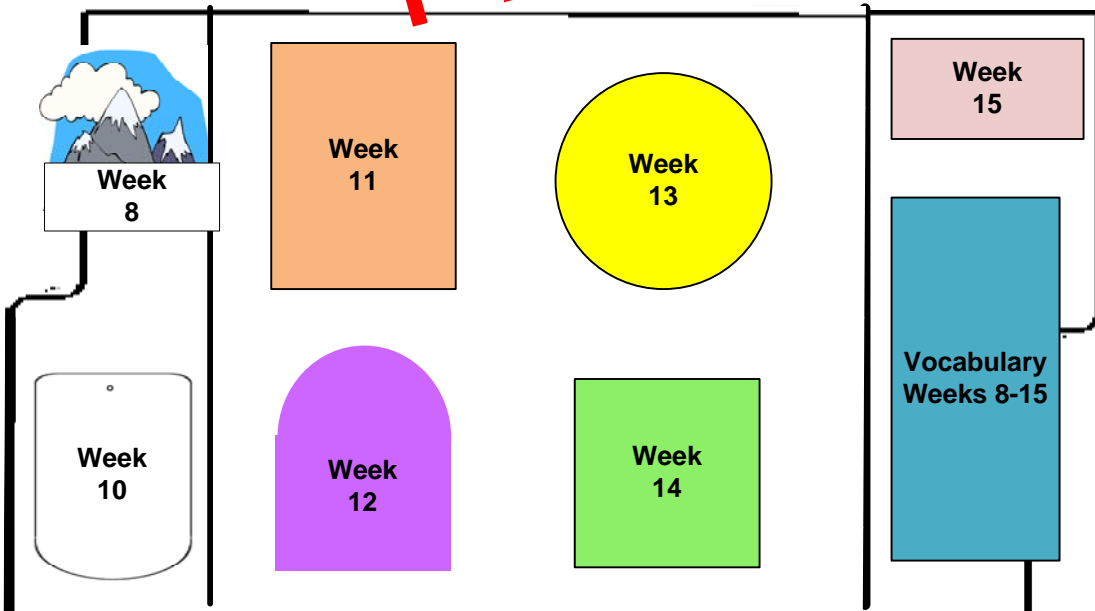

This guide shows where to place the mini-booklets in each folder.

Folder 3 Weeks 16-23

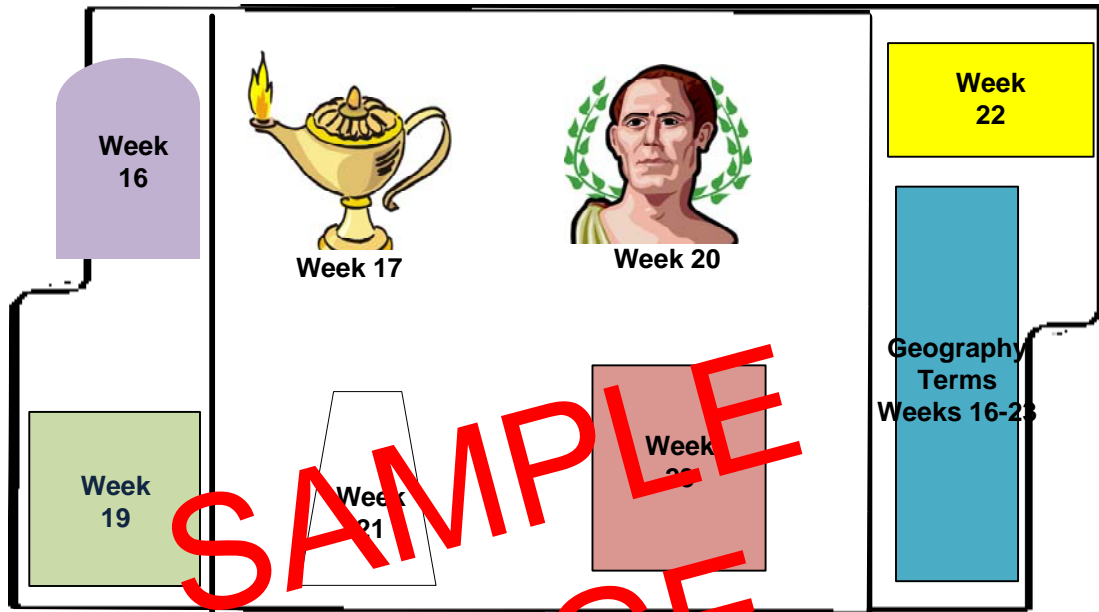

Folder 4 Weeks 24-29

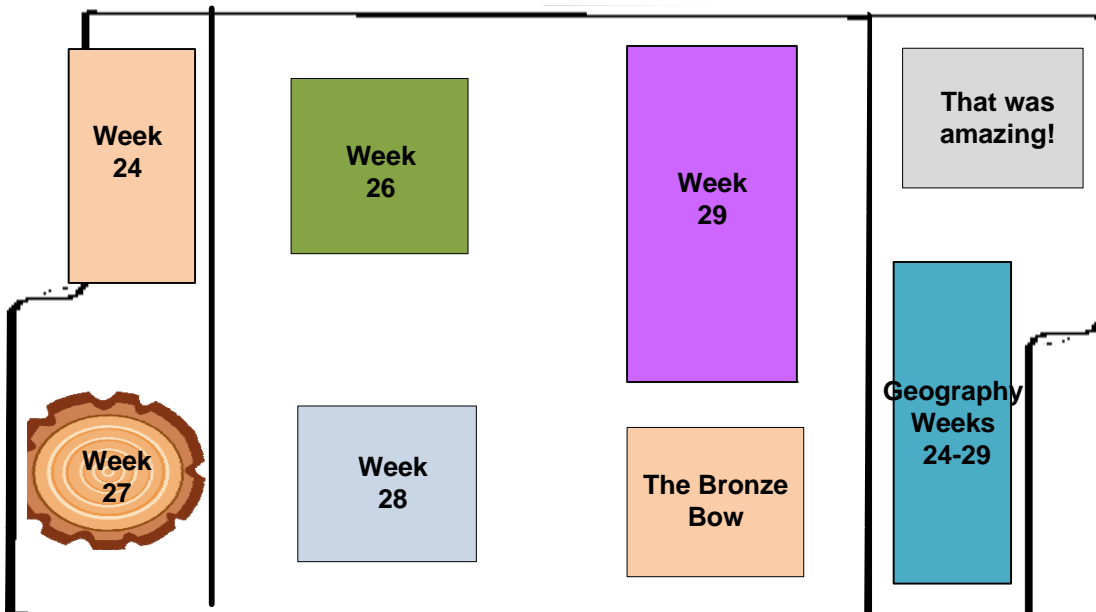

Week 1 Abraham: Ur to Egypt

Folder 1

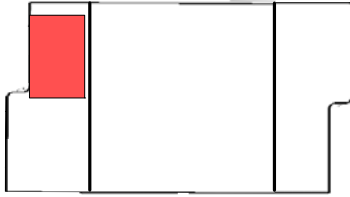

Cut out each booklet. Stack on top of each other with the cover sheet on top. Attach together with a brad or a piece of ribbon. Glue into lapbook. **Trail Blazing: Study the Fertile Crescent.** Fill out the information on each booklet.

X

The Fertile Crescent



Made fertile by:

Origin of name:

SAMPLE PAGE

Climate:

Crops:

Week 17 The Maccabees: Jewish traditions

Folder 3

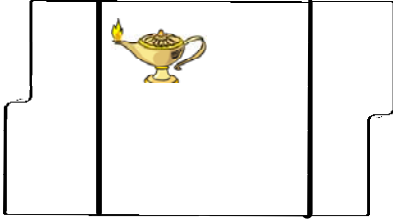

Hamburger fold on the middle line. Cut out around shape of the lamp. Glue into lapbook. **Trail Blazing: According to Jewish tradition,...** Fill out the information about oil lamps in the booklet.

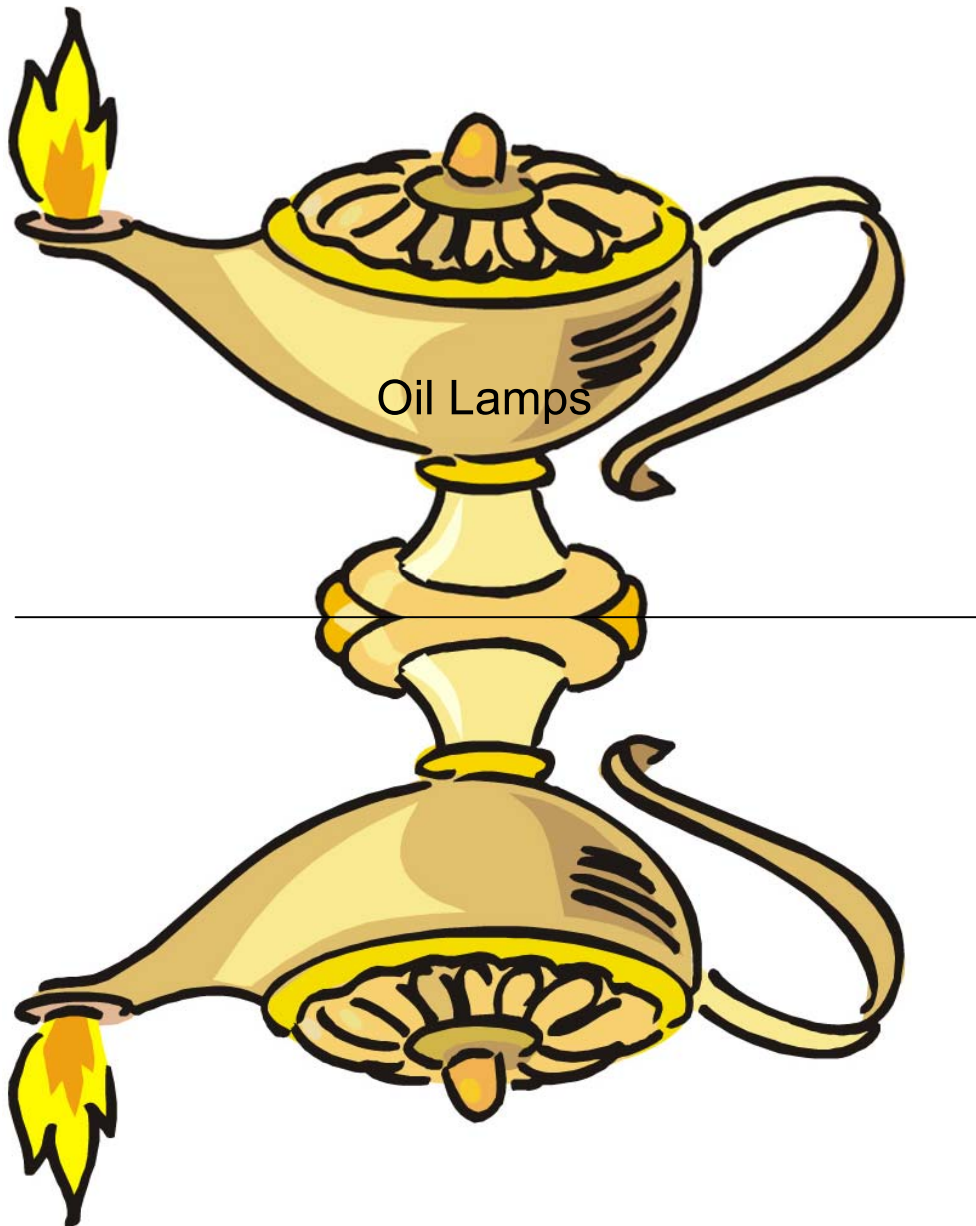

Folder 2

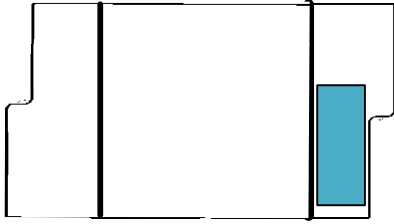

Weeks 8-15 Geography Terms

Cut out as one piece. Hotdog fold in the middle so that words are on top. Cut along dotted lines to create tabs. Glue into lapbook. Write definition of words under tab. This activity can be done weekly or at the end of the 8-15 weeks.

	Desert
	Cliff
	Tell
	Stream
	Plateau
	River
	Savanna(h)

**SAMPLE
PAGE**

Week 29 Dead Sea Region: Dead Sea

Folder 4

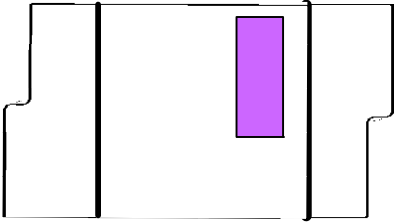

Cut out the booklet as one piece. Hotdog fold in half. Glue into lapbook. **Trail Blazing: Learn how the Dead Sea is its own mini-universe with its own micro-climate.** Inside the booklet, write a summary of this unique part of the world. Include pictures if possible.

The Dead Sea



**SAMPLE
PAGE**

GLUE

Folder 4

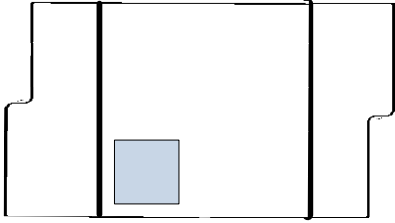

Week 28 Mediterranean Sea: Ephesus

Cut out the booklet. Hotdog fold the flaps inward on the lines. Glue cover label on top of closed booklet and then cut across the middle of the cover page so that booklet will open. Glue into lapbook. **Trail Blazing: Paul established churches in Ephesus,...** Answer the questions in the booklet.

Hotdog fold

Famous Amphitheater

Hotdog fold

What I have learned about the city:

How Mediterranean contributed to development of city

Cover label



Ephesus

The Bronze Bow

Folder 4

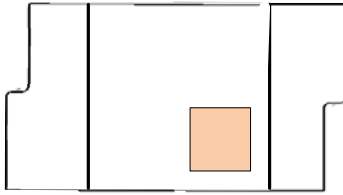

Cut out the booklet as one shape. DO NOT CUT OFF FLAPS. Fold bottom square back, then fold back the two flaps over and glue. This will create a pocket. Glue into lapbook.

Character Study- First, read directions for character study in your book. (p. 84) The cards from the next 3 pages are to be cut out and used to write a paragraph about the character listed. The pieces will be stored in this pocket.

Glue flap down	<h1>The Bronze Bow</h1> <p>by</p> <h2>Elizabeth George</h2> <p>Speare</p> <h1>SAMPLE PAGE</h1>	Glue flap down

Store cards in the pocket when not in use.

Daniel

Joel

Thacia (Malthace)

Rosh

**SAMPLE
PAGE**